

OKLAHOMA DEPARTMENT OF TRANSPORTATION					
FED. ROAD DIST. NO.	STATE	PROJ. NO.	FISCAL YEAR	SHEET NO.	TOTAL SHEETS
	OKLA.				
DESCRIPTION			REVISIONS	DATE	

STATE OF OKLAHOMA
DEPARTMENT OF TRANSPORTATION

SURVEY OF
U.S. 62, ROGERS LANE & I-44
SWO 2488(1)
J/P NO. 27050(04)
OKLAHOMA
INTERSECTION SURVEY AT U.S. 62,
ROGERS LANE & I-44

STATE OF OKLAHOMA
DEPARTMENT OF TRANSPORTATION
SURVEY DIVISION

SWO 4488(1) J/P 27050(04) ; U.S. 62 CO. Comanche

HORIZONTAL CONTROL:
 Oklahoma Coordinate System of 1927 _____ Zone.
 Oklahoma Coordinate System of 1983 (93) South Zone.
 Oklahoma Dept. of Transportation Plane Coordinate System of 1927 _____ Zone.
 Oklahoma Dept. of Transportation Plane Coordinate System of 1983 _____ Zone.
 Arbitrary Coordinate System

HORIZONTAL PLANE DATUM DEFINITION:
 Oklahoma Department of Transportation coordinates were derived by multiplying the Oklahoma Coordinate Systems of 1927 or 1983 by the combined adjustment factor of 1.00010. The ODOT Coordinate System is 2350 feet above sea level.

1. SWO 4488(1) adjusted to H.A.R.N. (B) Order
 Stations "TWO" and to ODOT Mon. No. C-16-783
 A) Closure before adjustment X _____ ; Y _____ Angles _____
 Trav. Length _____ No. Angles _____ ; T: _____
 B) _____ ; is Order before adjustment.
 C) Method of Distance Measurement:
 Electronic GPS Triangulation Tied
 D) Instrument used for angles Leica SR530 Dual Freq. GPS Receiver

2. Centerline adjusted to GPS Primary (B) Order
 Stations "TWO" and to ODOT Mon. No. C-16-783
 A) Closure before adjustment X _____ ; Y _____ Angles _____
 B) _____ ; is Order, Tied to _____
 C) Method of Distance Measurement:
 Electronic GPS Triangulation Tied
 D) Instrument used for angles Leica TC 1800 Total Station

VERTICAL CONTROL IS (3rd) der. Level Line taken from SWO3848(1) BM #13 & 15
(2nd) order and tied to SWO 3748(1) Survey (3rd) order. NGVD 29 datum
 NAVD 88 datum

ACCURACY DEFINITION:
 (1) HORIZONTAL: (3rd Order = Class I = 1 : 10,000')
 (3rd Order = Class II = 1 : 5,000')
 (2) VERTICAL: (1st Order = 0.017 Ft. x sqrt. of Mi. | 2nd Order = 0.035 Ft. x sqrt. of Mi.)
 (3rd Order = 0.050 Ft. x sqrt. of Mi.)

INDEX OF SHEETS

1.	TITLE SHEET
2 - 7.	HISTORICAL LETTER
7 - 19.	COGO POINTS & ALIGNMENT DATA
18 - 19.	BENCHMARKS & CHECK LEVELS
20 - 26.	SURVEY DATA SHEETS
27.	GEOMETRIC DATA SHEET

SURVEY BEGAN: SEPTEMBER 14, 2009
 SURVEY COMPLETED: MARCH 29, 2011
 ADDITIONAL INFORMATION: APRIL 2, 2012

PERSONNEL:
 DANNY R. DEES, PLS. PROF. LAND SURVEYOR II
 RUSSELL L. SHAFER. TRANS. SPEC. II
 JOE L. GOMBA. TRANS. SPEC. II
 MARCELYNO R. MILLER. TRANS. SPEC. I

Equipment Used:
 Leica TC1800 Total Station. SER. No. 420376
 Leica TPS100 Total Station. ET-329 213501
 Leica NA2002 Digital Level. EL-413 91545
 Carlson Data Recorder. EE-124 11256
 Allegro Data Recorder. EC-0024 51603
 Leica SR530 GPS Receiver. EE-119 36910
 Leica SR530 GPS Receiver. EE-124 36731
 Leica SR530 GPS Receiver. EE-133 36764
 Leica GX1230 GPS Receiver. EE-208 461023
 Leica Viva GNSS GS-15. EE-264 1505408
 Leica Viva GNSS GS-15. EE-265 1505456

Distribution: D. R. Dees
 Copy w/survey reports _____
 Copy in each Alignment _____
 and level book _____
 Professional Land Surveyor

March 29, 2011
 Date

(FORM SD #20)
 Rev. 11/03

STATE OF OKLAHOMA
DEPARTMENT OF TRANSPORTATION

SWO 4488(1) Job/Piece 27050(04) Engr. Contract No. _____

LAND SURVEYOR'S CERTIFICATION

I hereby certify that all land and property sub-division distances, angles, corners and monumentation made or used in conjunction with this survey and depicted or recorded herein or hereon were recovered, established or re-established in substantial conformity with:
 - applicable instructions contained in the U.S. Government Bureau of Land Management publication "Manual of Surveying Instructions";
 - its supplement, "Restoration of Lost or Obliterated Corners and Sub-division of Sections";
 - "Oklahoma Minimum Standards for the Practice of Land Surveying" as adopted by the State Board of Registration for Professional Engineers and Land Surveyors, and
 - sound land surveying practices, including a thorough search, study, analysis and consideration of all existing records and field evidence.
 I further certify that all survey monuments depicted exist and that all land survey work was done by me or under my direct supervision and that it is true, accurate and correct to the best of my knowledge and belief.

Dated this 29th day of March, 2011.

Land Surveyor D. R. Dees
 Signature _____
 DANNY R. DEES
 Printed Name

Oklahoma Registered Land Surveyor No. 1344
 Certificate of Authorization No. _____ Exp. Date _____

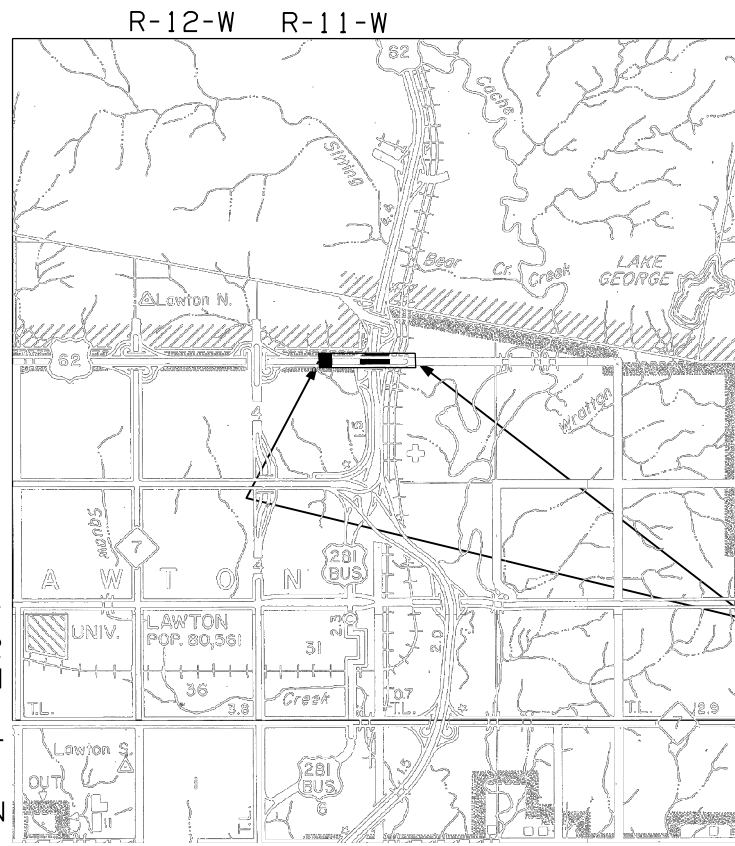
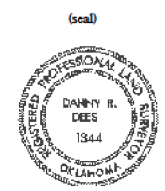

PROJECT EXTENTS

PROJECT LENGTH 3500 Ft. 0.66 MI.

BEGINNING STATION : 388+88.25
 ENDING STATION : 423+88.25

UTILITY OWNERSHIPS

TELEPHONE LINES:
 Indian Nation Fiber Optics - Lawton, Oklahoma (580) 355-2300
 AT & T Communications - Lawton, Oklahoma
 Ft. Sill Communications - Ft. Sill, Oklahoma (580) 248-2060

TELEVISION:
 Fidelity Communications - Lawton, Oklahoma (580) 353-2250

WATER LINES:
 City of Lawton - Lawton, Oklahoma (580) 581-3456
 American Water - Ft. Sill, Oklahoma (580) 248-3034

ELECTRIC LINES:
 Public Service of Oklahoma - Lawton, Oklahoma
 City of Lawton - Lawton, Oklahoma (580) 581-3456
 Department of Public Works - Ft. Sill, Oklahoma (580) 442-3251

GAS LINES:
 Oklahoma Natural Gas - Ft. Sill, Oklahoma (580) 335-7539
 Center Point Energy - Lawton, Oklahoma (580) 512-5924

SANITARY SEWER LINES:
 City of Lawton - Lawton, Oklahoma (580) 581-3456
 Department of Public Works - Ft. Sill, Oklahoma (580) 442-3251

THIS SURVEY MEETS THE OKLAHOMA MINIMUM STANDARDS FOR THE PRACTICE OF LAND SURVEYING AS ADOPTED BY THE OKLAHOMA STATE BOARD OF REGISTRATION FOR PROFESSIONAL ENGINEERS AND LAND SURVEYORS, MAY 17, 2010.

Electronic File Transfer Disclaimer:
 These Files, Drawings and/or Notes are provided for information only. The Oklahoma Department of Transportation (ODOT) and the Owner cannot be held responsible for the content or accuracy of these Files, Drawings and/or Notes due to conversions, software translations, or any other manipulation of said Files, Drawings and/or Notes. ODOT expressly disclaims any responsibility arising from any use of these Files, Drawings and/or Notes. To the full extent permitted by applicable law, the recipient of these Files, Drawings and/or Notes hereby agrees to defend, indemnify, and hold harmless ODOT and the Owner from and against any and all claims, suits, actions, damages, loss, liability or costs of every nature or description (including reasonable attorney's fees) arising from, or in any way attributable to or connected with any of these Files, Drawings and/or Notes.



OKLAHOMA DEPARTMENT OF TRANSPORTATION SURVEY DIVISION			
SURVEY DATA SHEET			
PLS	DRD		
DRAWN	DRD		
CHECKED			
APPROVED			
CREW	LAWTON	SWO <u>4488</u> (1) PROJECT NO. <u>27050(04)</u> SHEET NO. <u>S-1</u>	